

MODEL C PACKER

Valve Bag Air Packer

Taylor's Model C Packers are engineered for most granular, free-flowing materials, such as seed, fertilizer, plastic pellets, grain and sand. These pneumatic packers introduced Taylor's patented reverse flow, and are designed to yield exact measurements at high speeds.

Package granular and free-flowing materials with speed and precision

- 15 to 125 lb capacity for valve bags
- Certified seeds
- Fertilizers
- Plastic pellets
- Grains
- Sand



Specifications

MODEL C PACKER



Diagram dimensions are for reference only

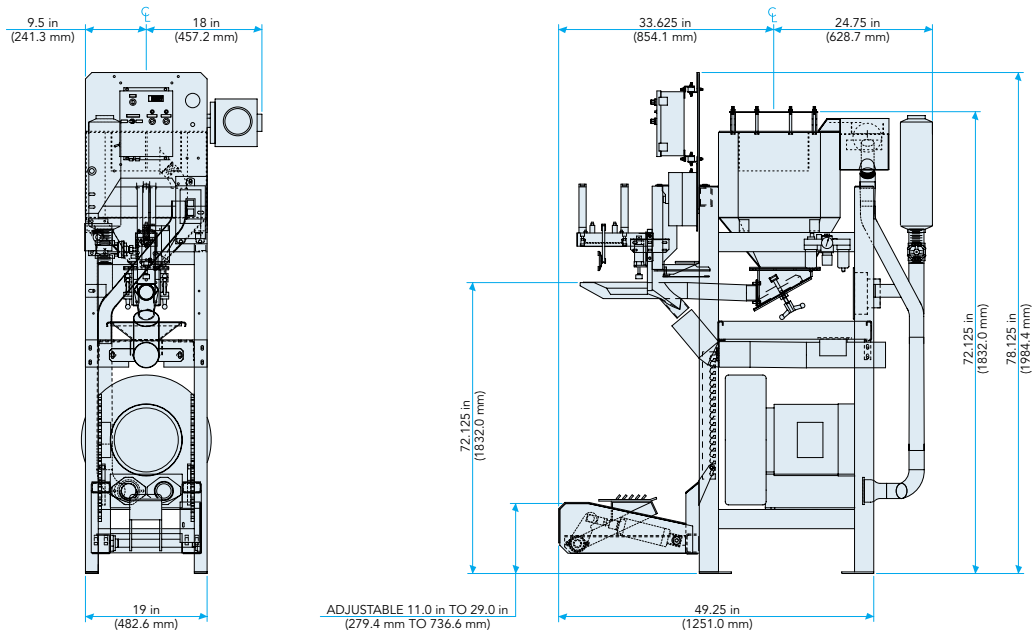

Dimensions	19.0 in x 49.25 in x 78.125 in (482.6 mm x 1,521.0 mm x 1,984.4 mm)
Speed	Up to 600 BPH/Spout
Accuracy	Up to 0.4%
Weight Range	15 lb to 125 lb (6.8 kg to 56.7 kg)
Scale	Analog, Digital
Configuration	Single or Multiple spouts
Construction	Carbon Steel Blasted and Painted
Electrical Requirements	230/460 Volt, 3 phase, 60 Hertz (Blower)
Air Requirements	90 PSI (6.2 BAR) 0.5 cubic feet (0.014 cubic meter) per cycle 200-300 CFM (dust control recommended)
Process Air	Integrated Regenerative Blower
Product Hopper	4,000 cubic inch (6,550 cubic centimeter) Capacity (standard)
Bag Discharge	Integrated Pneumatic Kicker (standard)
Bag Clamp	Integrated Pneumatic Clamp (standard)
Product Cut-off	Pop-Off Vent (No Pinch on Fill Tube)
Spout Size	1.5-in (3.81 cm) diameter, up to 2.5-in (6.45 cm) diameter
Popular Options	Stainless Steel Construction and/or contact areas, Flip Over Spout Printer, Multiple Setup



©2003 Magnum Systems, Inc. All rights reserved. Catalog number: MS.1008.1103



www.magnumsystems.com

Toll Free 888.882.9567 Phone 620.421.5550 Fax 620.421.5531

2205 Jothi Avenue, Parsons, Kansas 67357-8460